

SENA

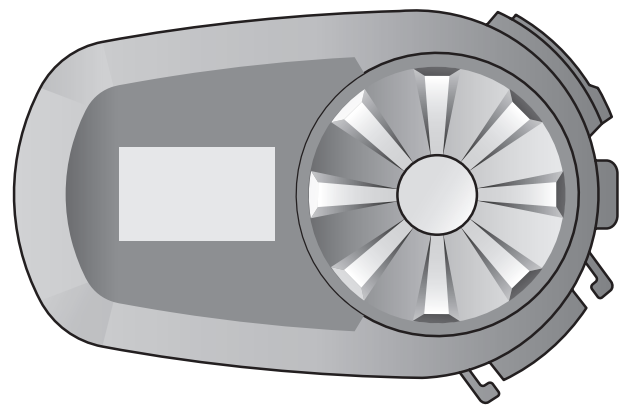

SS

**MOTORCYCLE BLUETOOTH[®]
COMMUNICATION SYSTEM**

HD SPEAKERS

USER'S GUIDE

LEGEND:



Tap button/Jog Dial the specified number of times



Press and Hold button/Jog Dial for the specified amount of time

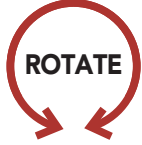

Rotate Jog Dial clockwise (right) or counterclockwise (left).



Rotate while Pressing Jog Dial clockwise (right) or counterclockwise (left).



"Hello"

Audible prompt

TABLE OF CONTENTS

1.	ABOUT THE MOTORCYCLE BLUETOOTH COMMUNICATION SYSTEM	6
<hr/>		
1.1	Product Details	6
1.1.1	Headset Main Unit	6
1.1.2	LCD Display	6
1.2	Package Contents	7
2.	INSTALLING THE HEADSET ON YOUR HELMET	8
<hr/>		
2.1	Helmet Installation	8
2.1.1	Using the Clamp Unit	8
2.1.2	Using the Glued Surface Mounting Plate	9
2.2	Installing the Speakers	9
2.3	Installing the Microphone	10
2.3.1	Installing the Attachable Boom Microphone	10
2.3.2	Installing the Wired Microphone	12
3.	GETTING STARTED	14
<hr/>		
3.1	Buttons	14
3.2	Downloadable Sena Software	14
3.2.1	Sena Utility App	14
3.2.2	Sena Device Manager	14
3.3	Powering On and Off	15
3.4	Charging	15
3.5	Checking the Battery Level	15
3.6	Volume Adjustment	16
4.	PAIRING THE HEADSET WITH OTHER BLUETOOTH DEVICES	17
<hr/>		
4.1	Phone Pairing	17
4.1.1	Initially Pairing the 5S	17
4.1.2	Pairing When the 5S is Turned Off	18
4.1.3	Pairing When the 5S is Turned On	19

4.2	Second Mobile Phone Pairing - Second Mobile Phone, GPS, and SR10	20
4.3	Advanced Selective Pairing: Hands-Free or A2DP Stereo	21
4.3.1	Phone Selective Pairing - Hands-Free Profile	21
4.3.2	Media Selective Pairing - A2DP Profile	22
4.4	GPS Pairing	23
5.	MOBILE PHONE USAGE	24
5.1	Making and Answering Calls	24
5.2	Speed Dialing	24
5.2.1	Assigning Speed Dial Presets	24
5.2.2	Using Speed Dial Presets	25
6.	STEREO MUSIC	27
6.1	Playing Music with Bluetooth Devices	27
6.2	Music Sharing	28
7.	BLUETOOTH INTERCOM	29
7.1	Intercom Pairing	29
7.2	Two-Way Intercom	30
7.3	Universal Intercom	31
8.	USING THE FM RADIO	32
8.1	FM Radio On/Off	32
8.2	Seek and Save Radio Stations	32
8.3	Scan and Save Radio Stations	33
8.4	Temporary Station Preset	34
8.5	Navigating Preset Stations	34
8.6	FM Sharing	35
8.7	Region Selection	35

9. VOICE COMMAND	36
<hr/>	
10. FUNCTION PRIORITY AND FIRMWARE UPGRADES	38
<hr/>	
10.1 Function Priority	38
10.2 Firmware Upgrades	38
11. CONFIGURATION SETTING	39
<hr/>	
11.1 Headset Configuration Setting	39
11.1.1 Delete All Pairings	39
11.1.2 Remote Control Pairing	40
11.2 Software Configuration Setting	40
11.2.1 Speed Dial	40
11.2.2 Unit Language	40
11.2.3 Audio Equalizer (Default: Off)	40
11.2.4 VOX Phone (Default: Enable)	41
11.2.5 VOX Intercom (Default: Disable)	41
11.2.6 Audio Source Priority (Default: Intercom)	41
11.2.7 Audio Multitasking™ (Default: Disable)	42
11.2.8 Background Volume (Default: Level 5)	43
11.2.9 HD Intercom (Default: Enable)	43
11.2.10 HD Voice (Default: Enable)	43
11.2.11 Sidetone (Default: Disable)	43
11.2.12 Voice Prompt (Default: Enable)	44
11.2.13 RDS AF Setting (Default: Disable)	44
11.2.14 FM Station Guide (Default: Enable)	44
11.2.15 Advanced Noise Control™ (Default: Enable)	44
12. TROUBLESHOOTING	45
<hr/>	
12.1 Fault Reset	45
12.2 Factory Reset	46

1. ABOUT THE MOTORCYCLE BLUETOOTH COMMUNICATION SYSTEM

1.1 Product Details

1.1.1 Headset Main Unit

DC Power Charging & Firmware Upgrade Port

LCD Display

Phone Button

Jog Dial

Speaker and Microphone Port

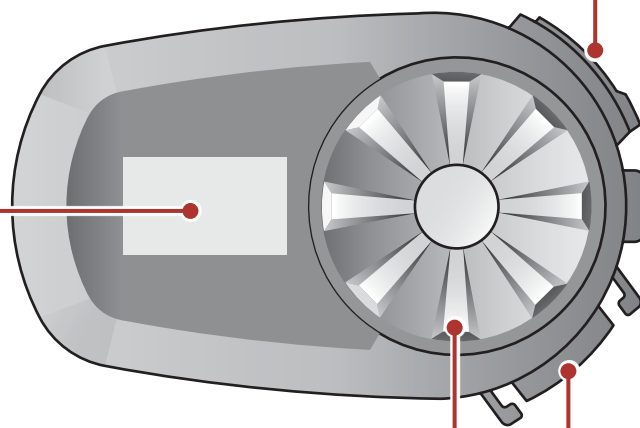

1.1.2 LCD Display

Status

Battery Indicator

Active Function



1.2 Package Contents

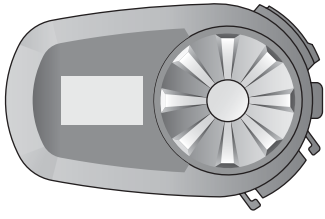

Headset Main Unit

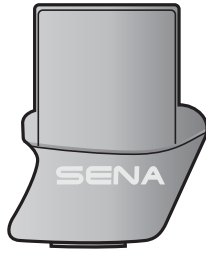

Clamp Unit

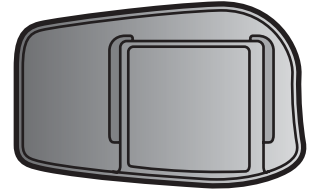

Glued Surface Mounting Plate

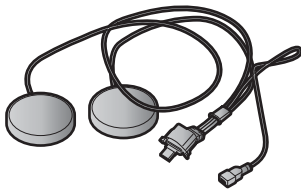

Speakers

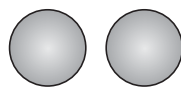

Speaker Pads

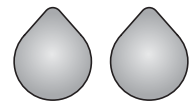

Hook and Loop Fasteners for Speakers



Wired Boom Microphone

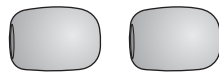

Microphone Sponges



Hook and Loop Fastener for Boom Microphone

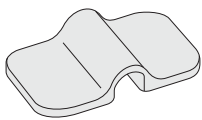

Boom Microphone Holder



Hook and Loop Fastener for Holder



Wired Microphone



Hook and Loop Fastener for Wired Microphone

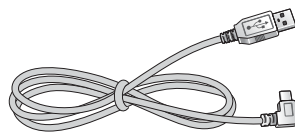

USB Power & Data Cable (USB-C)



Allen Wrench

2. INSTALLING THE HEADSET ON YOUR HELMET

2.1 Helmet Installation

2.1.1 Using the Clamp Unit

1. Loosen the two screws on the back plate of the clamp unit with the included Allen wrench.

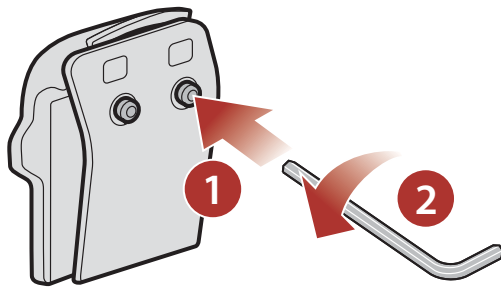

2. Insert the back plate of the clamp unit between the internal padding and external shell of the left side of the helmet.

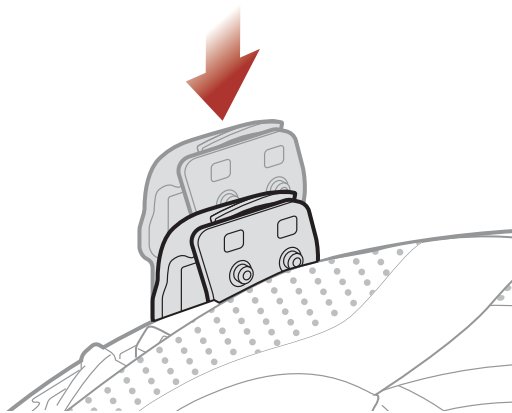

3. Tighten the two screws until the clamp unit is fastened firmly to the helmet.

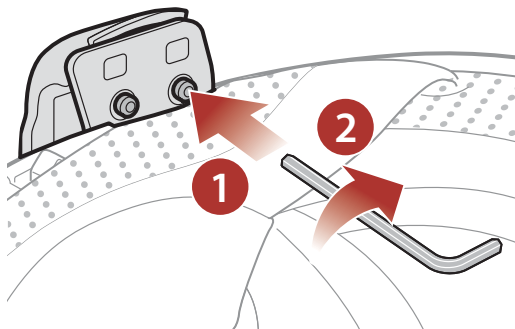

4. Attach the main unit to the clamp unit until you hear a click.

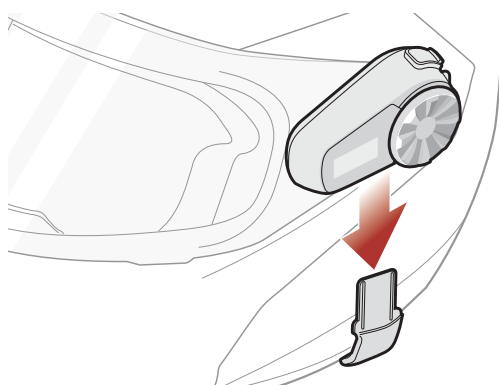

2.1.2 Using the Glued Surface Mounting Plate

If you cannot install the clamp unit on the helmet, you can use the glued surface mounting plate to attach the clamp unit to the surface of the helmet.

1. Attach adhesive tape of the glued surface mounting plate to the helmet.



2. Make sure that the glued surface mounting plate sticks on the helmet firmly. Maximum adhesion occurs after 24 hours.
3. Attach the main unit to the glued surface mounting plate until you hear a click.

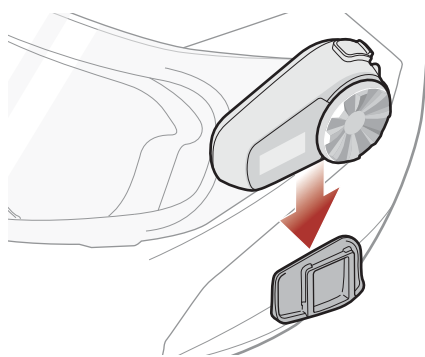

2.2 Installing the Speakers

1. Attach the hook and loop fasteners for speakers to ear pockets inside the helmet.

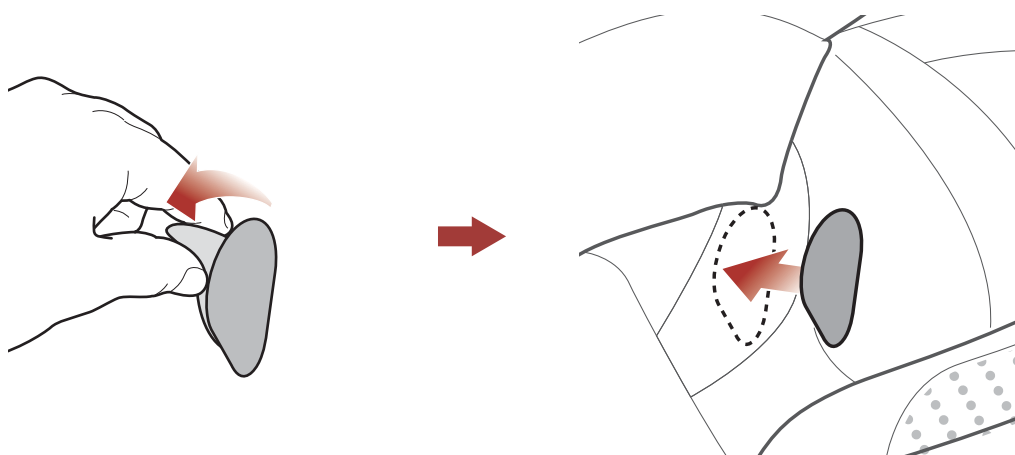

2. Attach the speakers to the hook and loop fasteners for speakers inside the helmet.

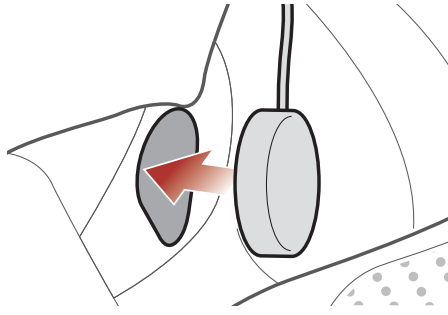

Note: If the helmet has deep ear pockets, you can use the speaker pads to bring the speakers closer to your ears.

2.3 Installing the Microphone

2.3.1 Installing the Attachable Boom Microphone

1. Attach the hook and loop fastener for attachable boom microphone on the inside surface of the left external shell.

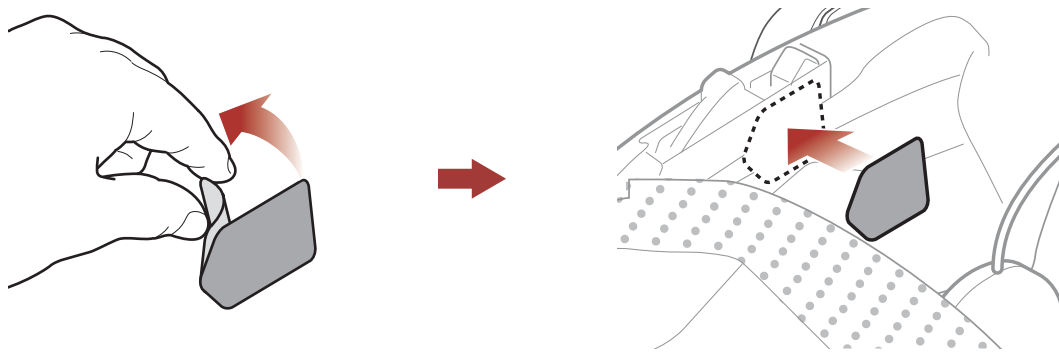

2. Attach the attachable boom microphone's mounting plate to the hook and loop fastener.

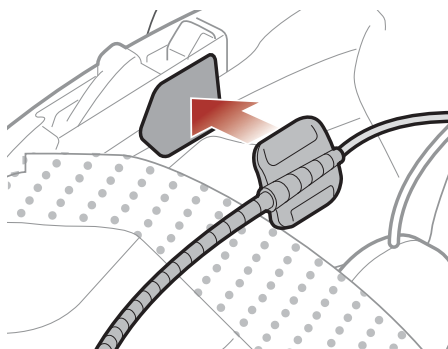

3. Adjust the head of the microphone so that the tab is facing away from your mouth.

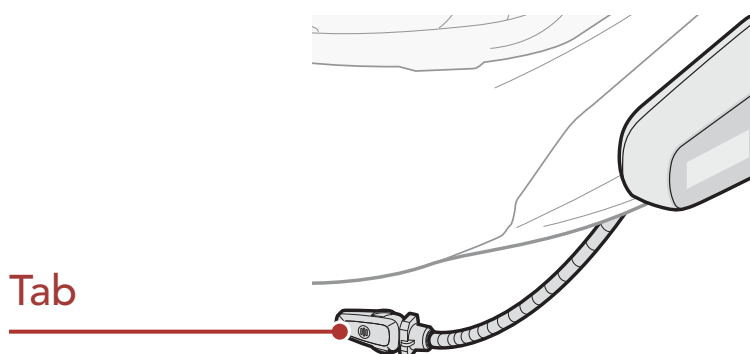

4. Align the arrows on the microphone and speaker cables and insert the microphone cable into the speaker cable.

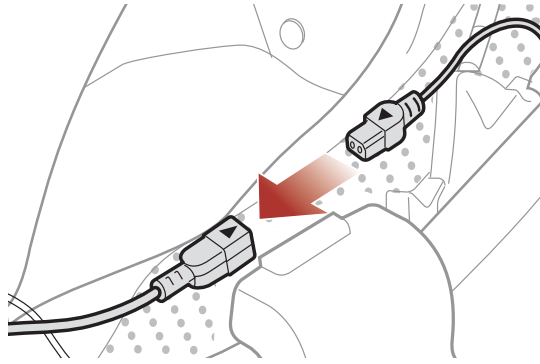

5. Insert the speaker connector into the speaker port to connect it to the main unit.

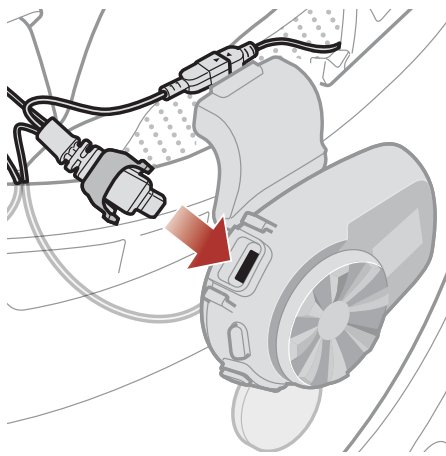

6. Close the cover of the speaker cable to lock the cable to the port.

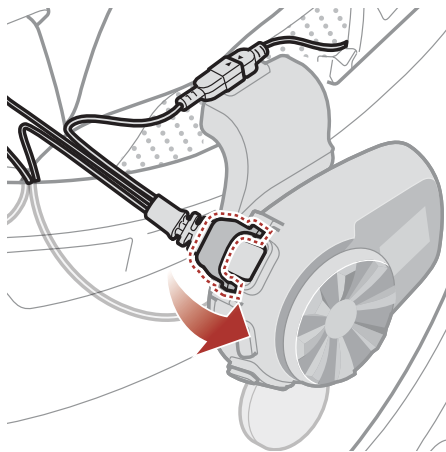

Note: You can use the boom microphone holder after attaching the hook and loop fastener for boom microphone holder on it to ensure secure installation.

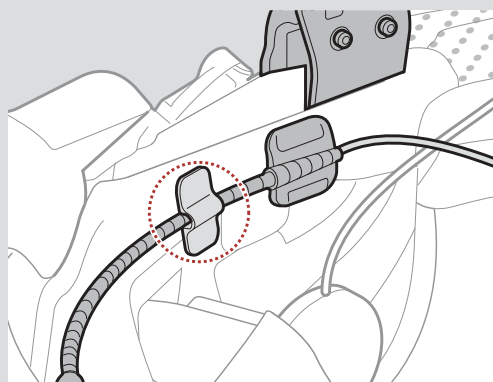

2.3.2 Installing the Wired Microphone

If you have a full face helmet, you can use the wired microphone.

1. Attach the included hook and loop fastener for wired microphone to the inside of the helmet's chin guard.

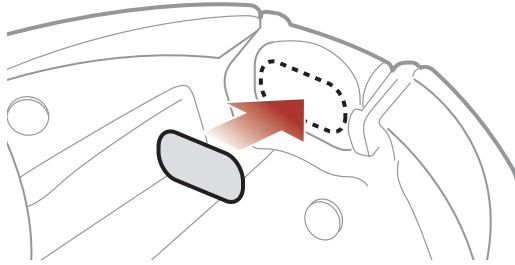

2. Attach the wired microphone to the hook and loop fastener for wired microphone.

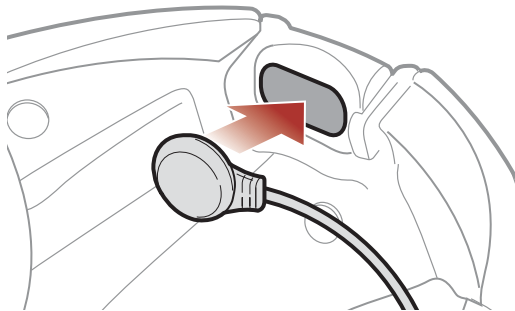

3. Align the arrows on the microphone and speaker cables and insert the microphone cable into the speaker cable.

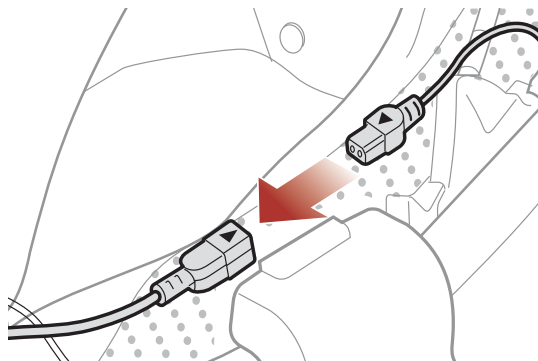

4. Insert the speaker connector into the speaker port to connect it to the main unit.

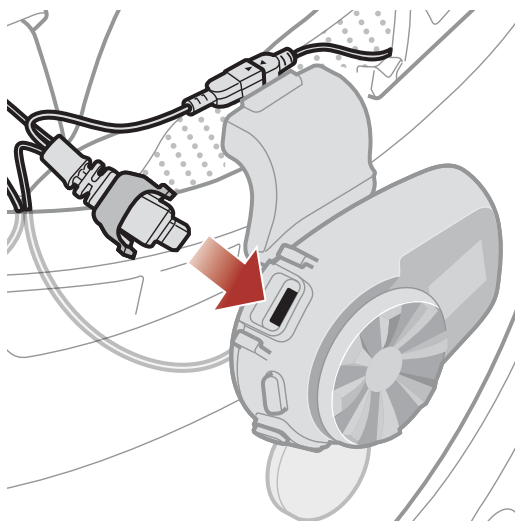

5. Close the cover of the speaker cable to lock the cable to the port.

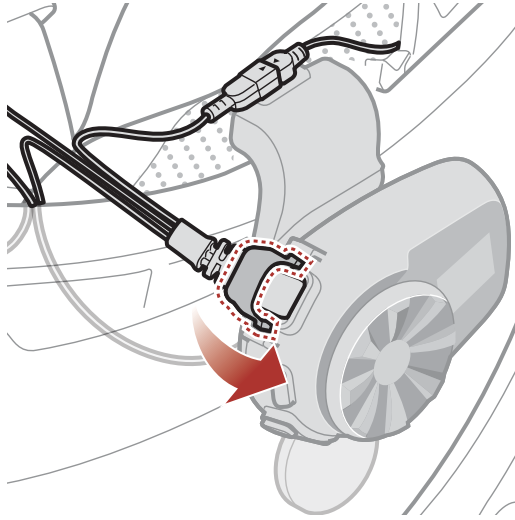

3. GETTING STARTED

3.1 Buttons

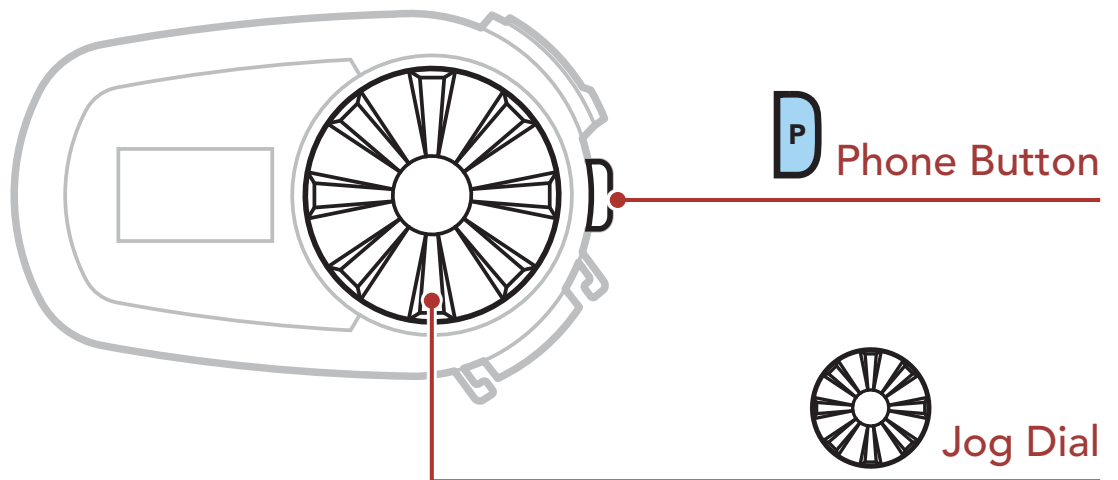

3.2 Downloadable Sena Software

3.2.1 Sena Utility App

By simply pairing your phone with your headset, you can use the **Sena Utility App** for quicker and easier set up and management.

- App Features
 - Music, FM Radio, Device settings, Quick Start Guide, and User's Guide
- Download
 - Android: Google Play Store > '**Sena Utility**'
 - iOS: App Store > '**Sena Utility**'



3.2.2 Sena Device Manager

The **Sena Device Manager** allows you to upgrade the firmware and configure its settings directly from your PC or Apple computer. Download the **Sena Device Manager** from sena.com.

[Click Here to Visit sena.com](http://sena.com)

3.3 Powering On and Off

Powering On



Powering Off



3.4 Charging

Charging the Headset

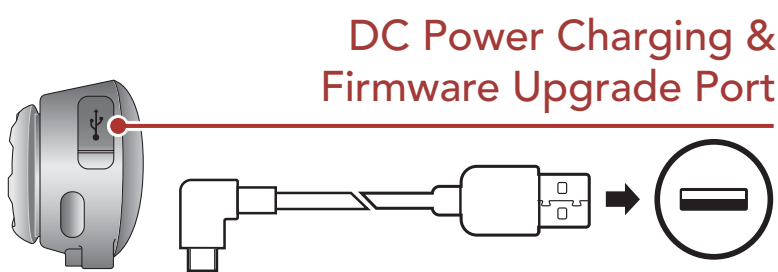

The headset will be fully charged in about 1.5 hour. (The charging time may vary depending on the charging method.)

Note:

- Any 3rd party USB charger can be used with Sena products if the charger is approved by either the FCC, CE, IC or other locally approved agencies that Sena accepts.
- The **5S** is compatible with 5 V input USB-charged devices only.

3.5 Checking the Battery Level

LCD Display

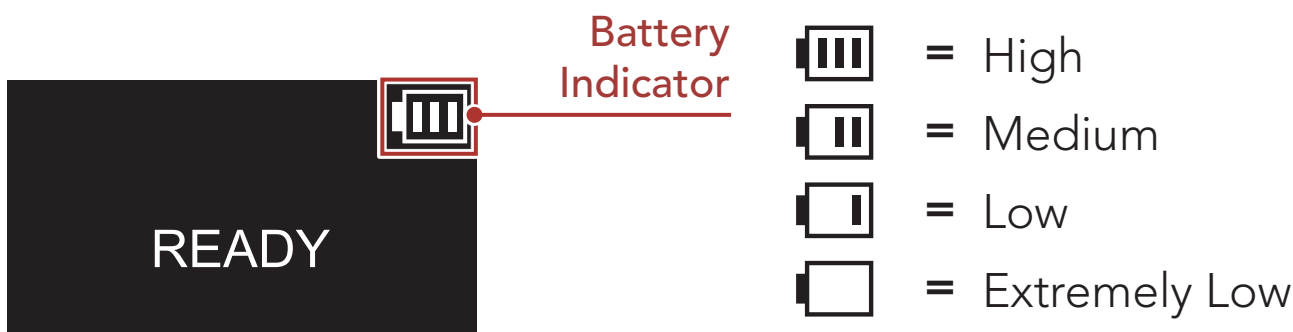

Note: When the battery is low while in use, you will hear a voice prompt saying **"Low battery"**.

3.6 Volume Adjustment

You can raise or lower the volume by rotating the **Jog Dial** clockwise or counterclockwise. Volume is set and maintained independently at different levels for each audio source (i.e., phone, intercom), even when the headset is rebooted.

Volume Up

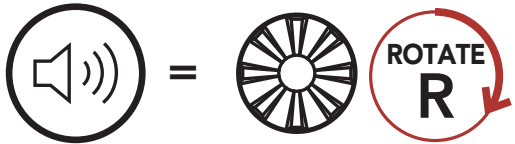

VOLUME
BAR



Volume Down

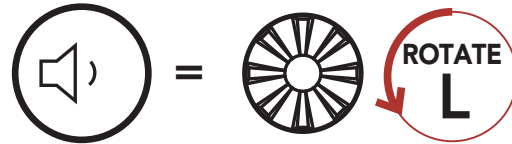

4. PAIRING THE HEADSET WITH OTHER BLUETOOTH DEVICES

When using the headset with other Bluetooth devices for the first time, they will need to be “paired.” This enables them to recognize and communicate with one another whenever they are within range.

The headset can pair with multiple Bluetooth devices such as a mobile phone, GPS, MP3 player or Sena SR10 Two-Way Radio Adapter via **Mobile Phone Pairing, Second Mobile Phone Pairing and GPS Pairing**. The headset can also be paired with up to three other Sena headsets.

Pairs with up to Three Sena Headsets

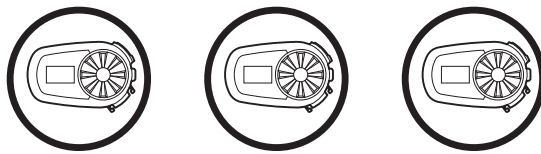

Also Pairs with:

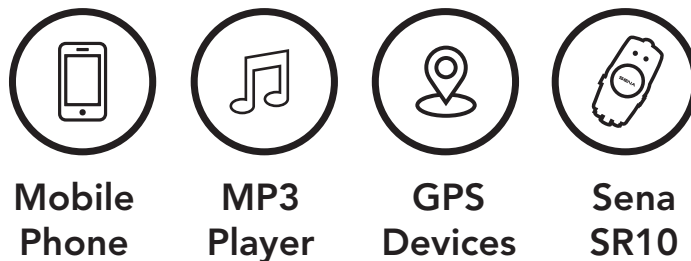

4.1 Phone Pairing

There are three ways to pair the phone.

4.1.1 Initially Pairing the 5S

The headset will automatically enter the phone pairing mode when you initially turn on the headset or in the following situations:

- Rebooting after executing the **Factory Reset** feature; or
- Rebooting after executing the **Delete All Pairings** feature.

1. Press and hold the **Phone Button** and **Jog Dial** for **1 second**.

Phone Pairing

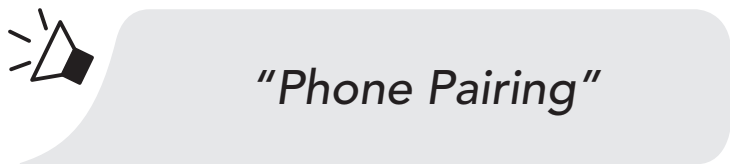

2. With your mobile phone in Bluetooth-pairing mode, select **Sena 5S** in the list of devices detected.
3. If your mobile phone asks for a PIN, enter 0000.

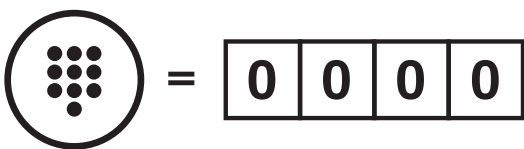

PIN NUMBER

Note:

- The phone pairing mode lasts for **3 minutes**.
- To cancel phone pairing, tap the **Phone Button** or **Jog Dial**.

4.1.2 Pairing When the 5S is Turned Off

1. Press and hold the **Phone Button** and **Jog Dial** for **3 seconds** when the **5S** is turned off.

Phone Pairing

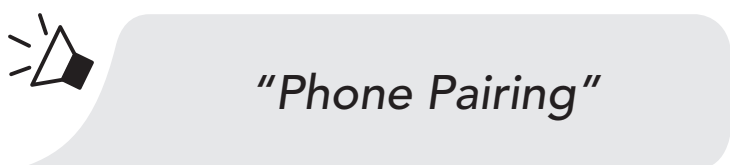
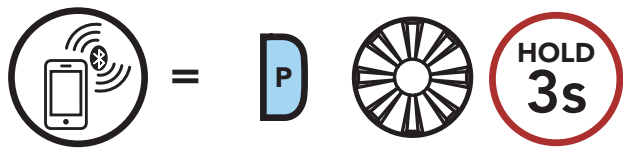

2. With your mobile phone in Bluetooth-pairing mode, select **Sena 5S** in the list of devices detected.
3. If your mobile phone asks for a PIN, enter 0000.

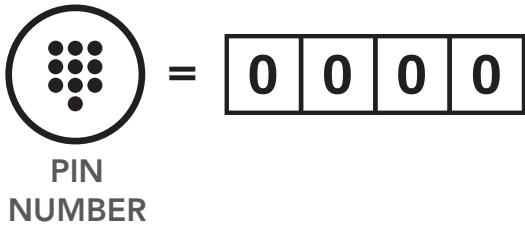

4.1.3 Pairing When the 5S is Turned On

1. Press and hold the **Phone Button** for **5 seconds** when the **5S** is turned on.

Phone Pairing

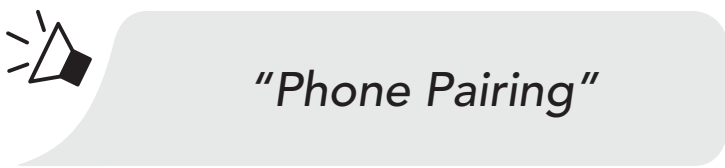
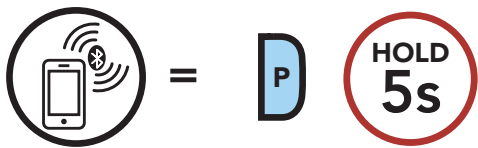

2. With your mobile phone in Bluetooth-pairing mode, select **Sena 5S** in the list of devices detected.
3. If your mobile phone asks for a PIN, enter 0000.

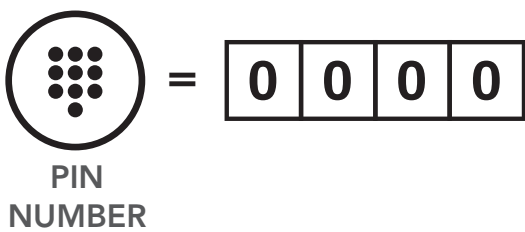

4.2 Second Mobile Phone Pairing - Second Mobile Phone, GPS, and SR10

1. Execute **Second Mobile Phone Pairing**.

Second Mobile Phone Pairing

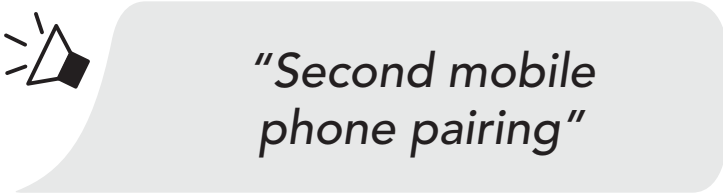
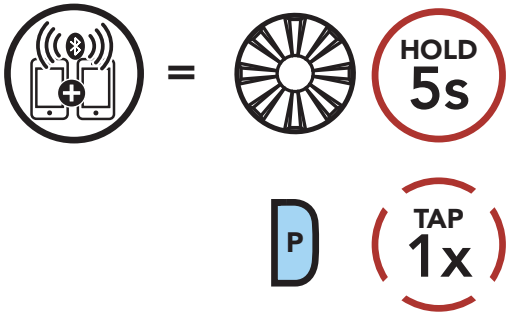

2. With your mobile phone in Bluetooth-pairing mode, select **Sena 5S** in the list of devices detected.

3. If your mobile phone asks for a PIN, enter 0000.

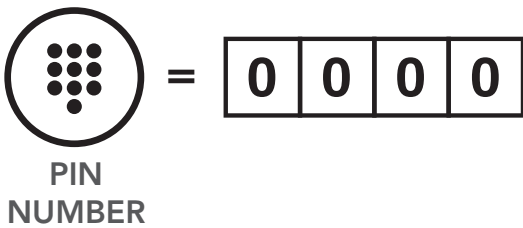

4.3 Advanced Selective Pairing: Hands-Free or A2DP Stereo

Phone Pairing allows the headset to establish two Bluetooth profiles: **Hands-Free** or **A2DP Stereo**. **Advanced Selective Pairing** allows the headset to separate the profiles to enable connection with two devices.

4.3.1 Phone Selective Pairing - Hands-Free Profile

1. Execute **Phone Selective Pairing**.

Phone Selective Pairing

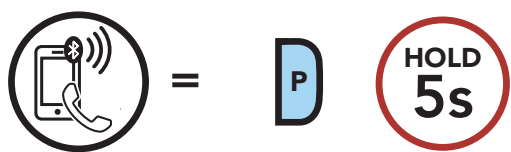

"Phone selective pairing"



=

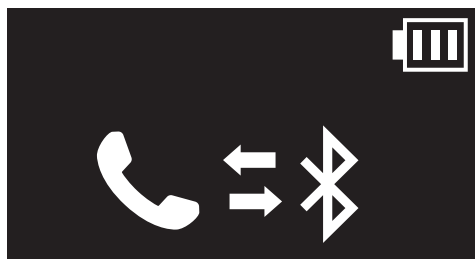

2. With your mobile phone in Bluetooth-pairing mode, select **Sena 5S** in the list of devices detected.

3. If your mobile phone asks for a PIN, enter 0000.

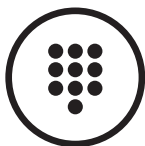

=



PIN
NUMBER

4.3.2 Media Selective Pairing - A2DP Profile

1. Execute **Media Selective Pairing**.

Media Selective Pairing

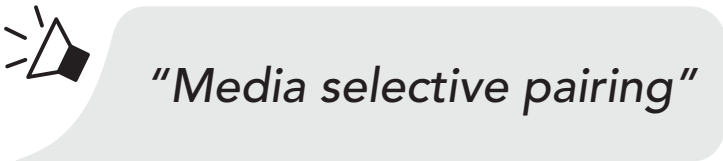
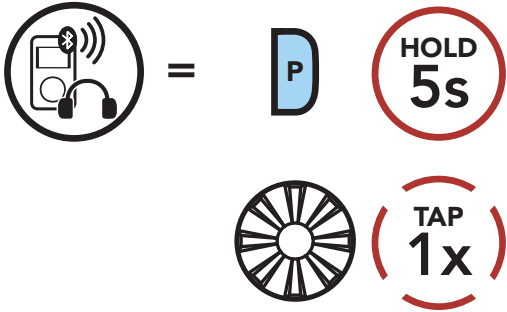

2. With your mobile phone in Bluetooth-pairing mode, select **Sena 5S** in the list of devices detected.

3. If your mobile phone asks for a PIN, enter 0000.

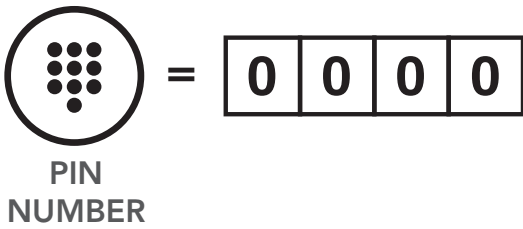

4.4 GPS Pairing

1. Execute **GPS Pairing**.

GPS Pairing

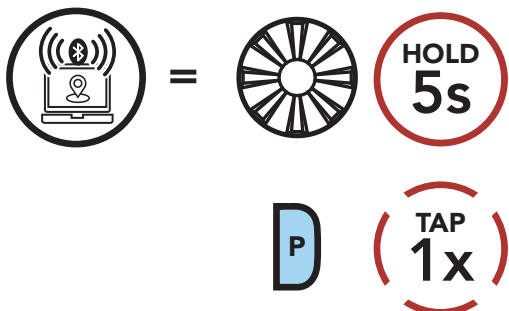

"Second mobile phone pairing"

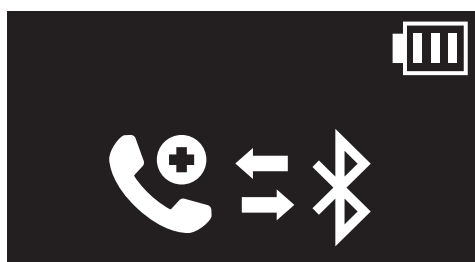

"GPS pairing"

2. With your Bluetooth device on the GPS navigation screen, select **Sena 5S** in the list of devices detected.

3. If your Bluetooth device asks for a PIN, enter 0000.

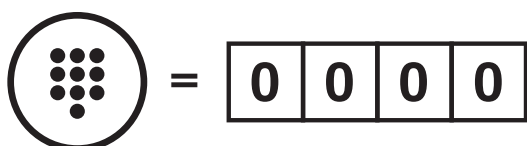

PIN
NUMBER

Note: If you pair your GPS device via GPS Pairing, its instruction will not interrupt your intercom conversations, but overlay with them. Bluetooth intercom conversations will be interrupted by GPS instructions.

5. MOBILE PHONE USAGE

5.1 Making and Answering Calls

LCD Display

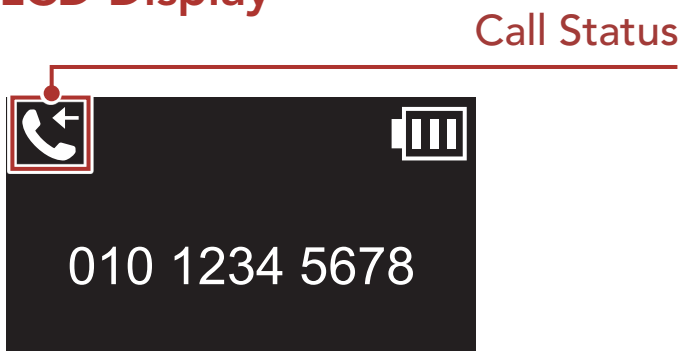

- = Incoming Call
- = Outgoing call
- = On the Phone Call
- = Reject a call

Answer a Call

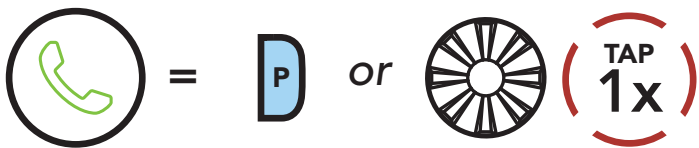

Reject a Call

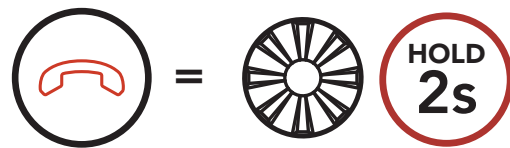

Make Call with Voice Dialer

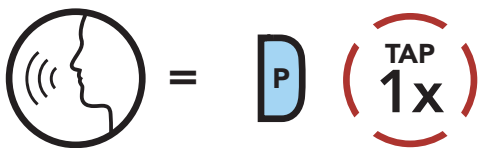

End a Call

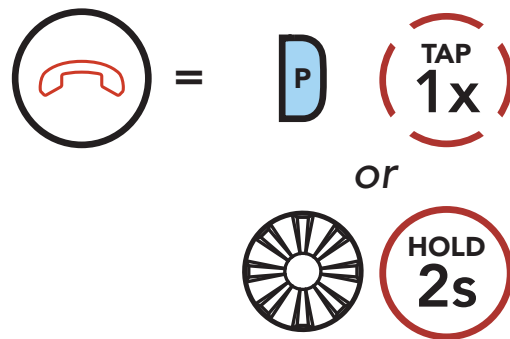

Note: If you have a GPS device connected, you will not hear its voice navigations during a phone call.

5.2 Speed Dialing

5.2.1 Assigning Speed Dial Presets

Speed Dial Presets could be assigned in the settings menu, accessible through **Sena Device Manager** or **Sena Utility App**.

5.2.2 Using Speed Dial Presets

1. Enter into the **Speed Dial** menu.

Enter Speed Dial Mode

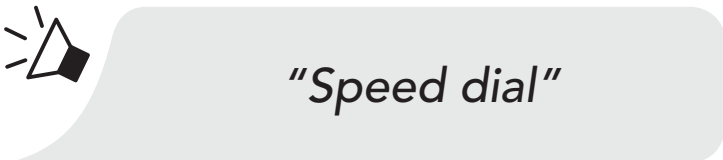
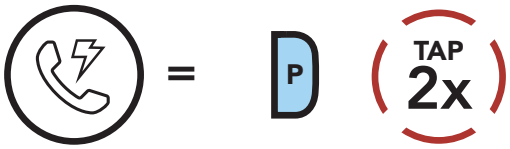

2. Navigate between the **Speed Dial Preset**.

Navigate Forward or Backward through Speed Dial Preset Numbers

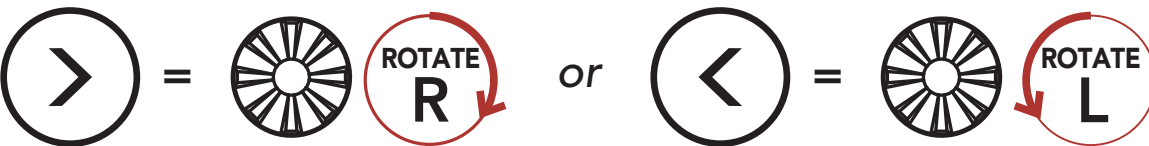

3. Call one of your **Speed Dial Presets**.

Call a Speed Dial Preset Number

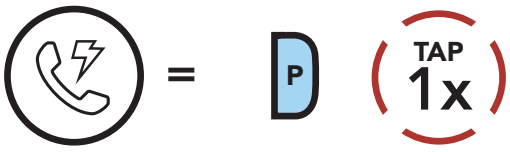

"Speed dial (#)"

4. Redial the last number called.

Redial Last Number

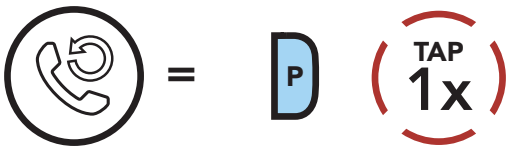

"Last number redial"

6. STEREO MUSIC

6.1 Playing Music with Bluetooth Devices

1. Play or pause music.

Play/Pause Music

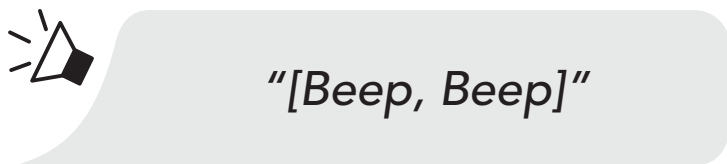
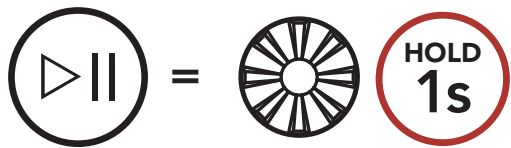

2. Adjust the volume.

Volume Up/Down



or

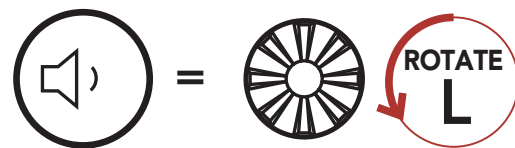

3. Track forward or back.

Track Forward/Backward



or

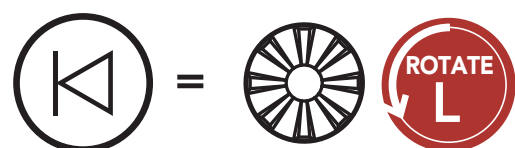

6.2 Music Sharing

You can start sharing music with an intercom friend using Bluetooth stereo music during a two-way intercom conversation. When you terminate music sharing, you can go back to the intercom conversation. To start or terminate sharing music, press the **Jog Dial** for **1 second** during an intercom conversation until you hear a double beep. To track forward or track back, rotate while pressing the **Jog Dial clockwise** or **counterclockwise**.

Music Sharing On/Off

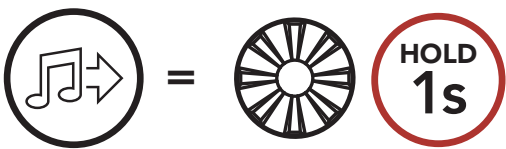

“[Beep, Beep]”

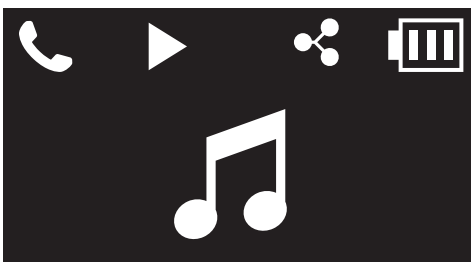

Note:

- Both you and your intercom friend can remotely control music playback such as track forward and track back.
- Music sharing will be paused when you are using your mobile phone or listening to GPS instructions.
- When Audio Multitasking is enabled, if an intercom call is made when you are listening to music, music sharing will not work.

7. BLUETOOTH INTERCOM

7.1 Intercom Pairing

Up to three people can communicate via intercom with the headset simply by pairing their headsets.

Pairing with Intercom Friends

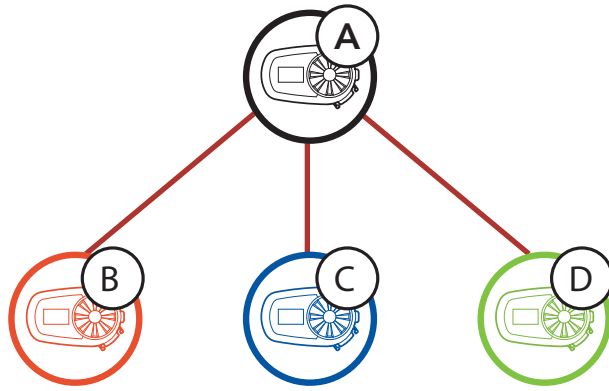

1. Press and hold the **Jog Dials** of two headsets for **5 seconds** until you hear a voice prompt, **"Intercom pairing"**.

Pairing Headset A with Headset B

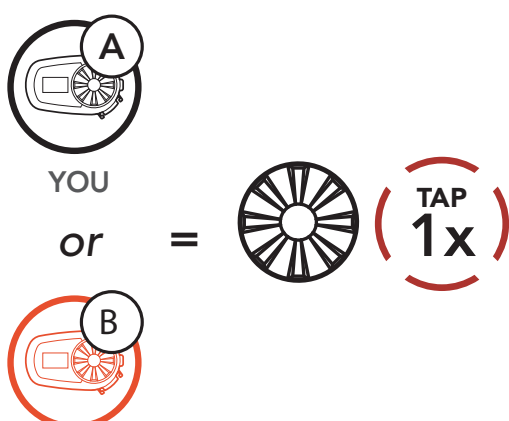
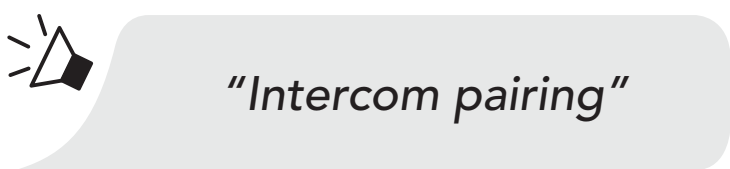
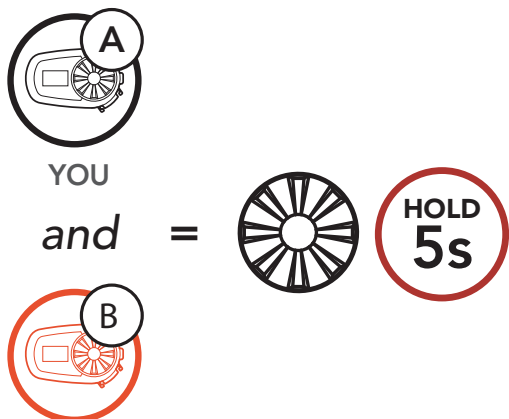

2. Repeat step 1 to pair with **Intercom Friends C & D**.

Last-Come, First-Served

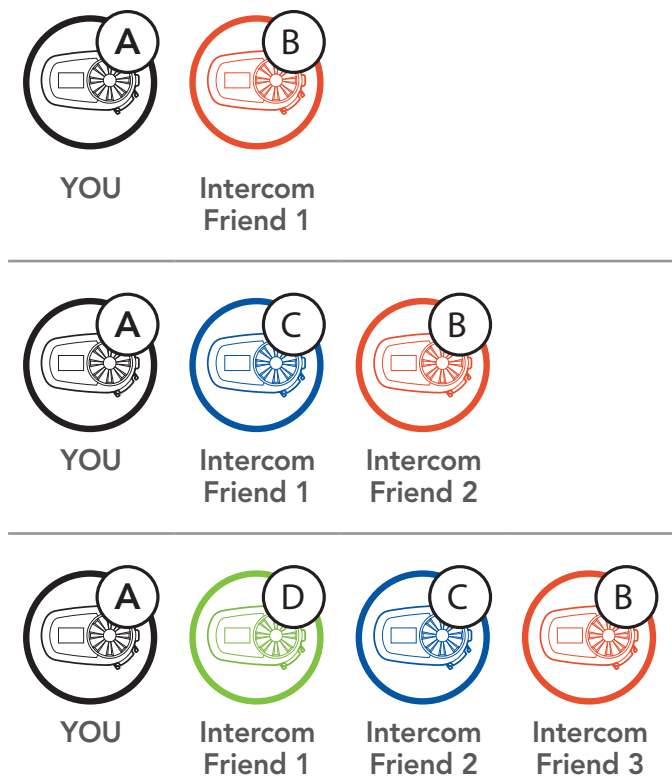

Intercom Conversation with Intercom Friend



7.2 Two-Way Intercom

You can start or end an intercom conversation with an Intercom Friend by tapping the **Jog Dial**.

1. Tap once for Intercom **Friend 1**.

Start/End with Intercom Friend 1

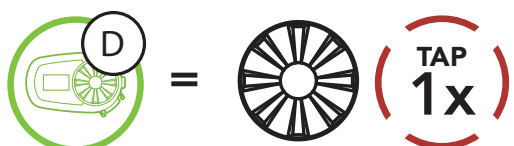

2. Tap twice for Intercom **Friend 2**.

Start/End with Intercom Friend 2

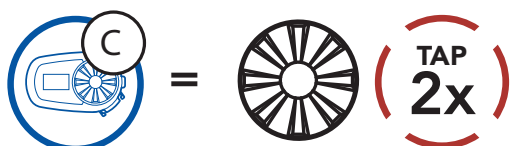

3. Tap three times for Intercom **Friend 3**.

Start/End with Intercom Friend 3

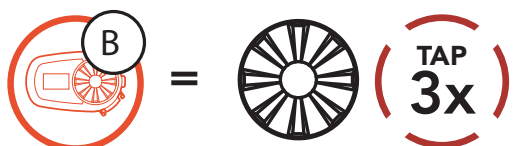

7.3 Universal Intercom

Universal Intercom allows you to have two-way intercom conversations with users of non-Sena Bluetooth headsets. You can pair your headset with only one non-Sena headset at a time. The intercom distance depends on the performance of the Bluetooth headset to which it is connected. When a non-Sena Bluetooth headset is paired with the Sena headset, if another Bluetooth device is paired via **Second Mobile Phone Pairing**, it will be disconnected.

1. Execute **Universal Intercom** in the **Headset Configuration Menu**.

Access Universal Intercom in the Configuration Menu

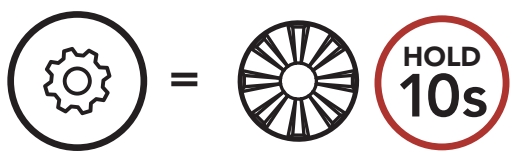

"Configuration menu"

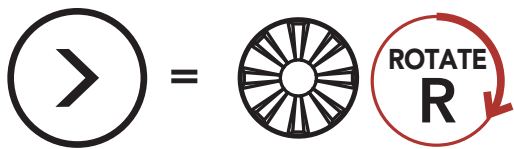

"Universal intercom pairing"

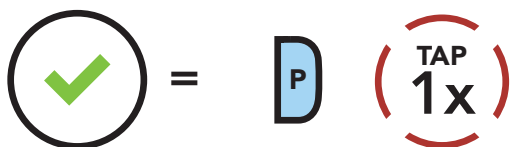
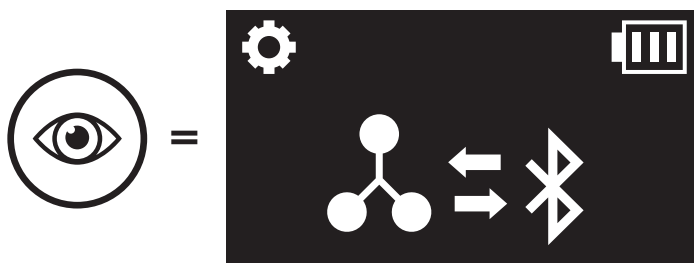

2. Put the non-Sena Bluetooth headset in Pairing Mode. The headset will automatically pair with a non-Sena Bluetooth headset.

8. USING THE FM RADIO

8.1 FM Radio On/Off

FM Radio On

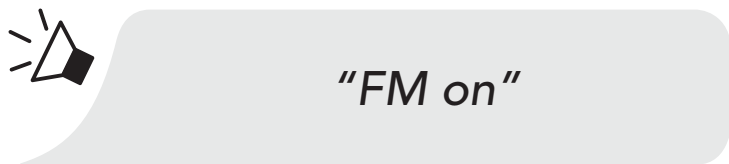
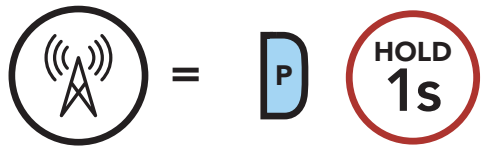

FM Radio Off

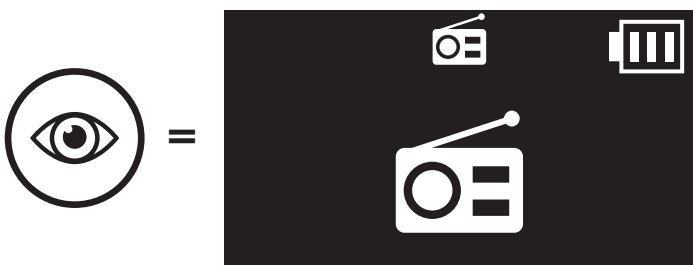
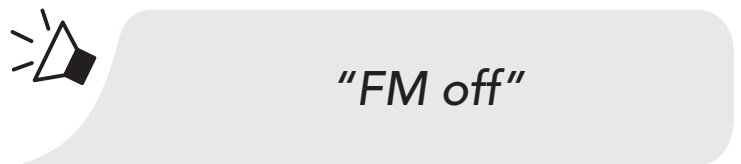
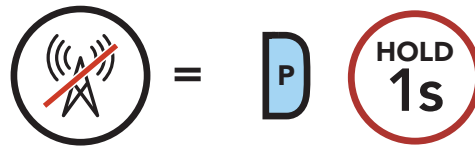

8.2 Seek and Save Radio Stations

The **"Seek"** feature searches for radio stations.

1. Search for radio stations.

Seek Stations Forward

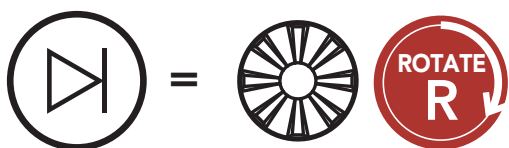

Seek Stations Backward

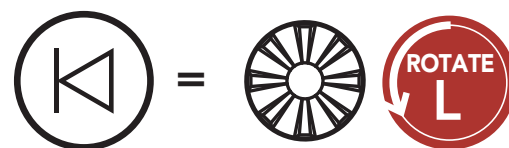

2. Save the current station.

Enter Preset Selection Mode

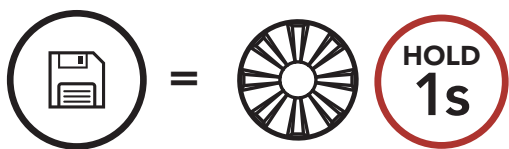

3. Navigate through the preset numbers that you want to store.

Navigate Forward/Backward Through Preset Stations

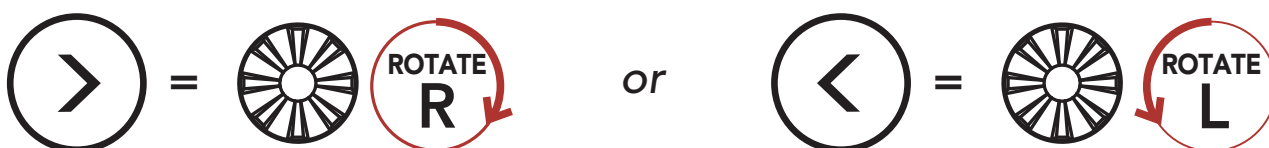

- Save the station in the preset number you choose or delete the station from memory.

Save Station to the Preset Number

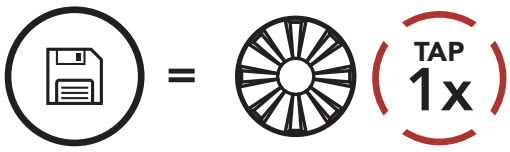

Delete Station from Memory

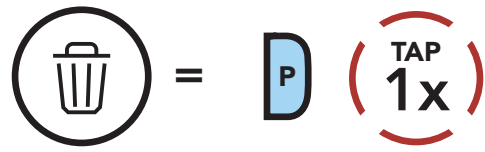

8.3 Scan and Save Radio Stations

The **“Scan”** function automatically searches for radio stations, starting with the current station’s frequency, then up from there.

- Scan for stations.

Start Scanning

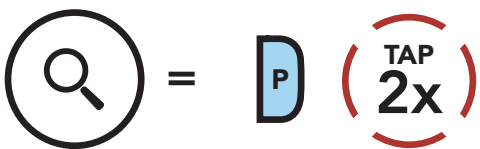

- The Sena tuner pauses at each station it finds for **8 seconds** before moving to the next.
- Save the current station. The station will be saved as the next preset number.

Save the Current Station

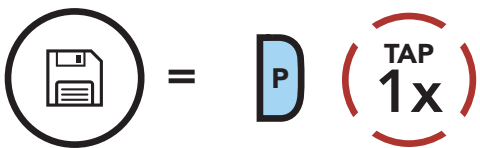

- Stop scanning.

Stop scanning

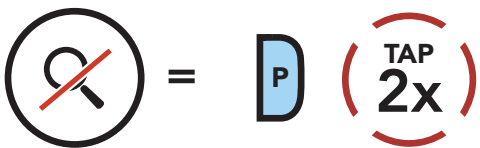

8.4 Temporary Station Preset

The **Temporary Preset** feature automatically finds and saves the nearest 10 radio stations without changing your existing preset stations.

1. Automatically find and save 10 stations.

Temporary Stations

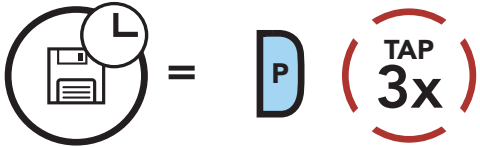

2. The temporary preset stations will be cleared when the headset reboots.

8.5 Navigating Preset Stations

Using the methods above, up to 10 radio stations can be stored. You can navigate through the saved stations.

Navigate through Preset Stations

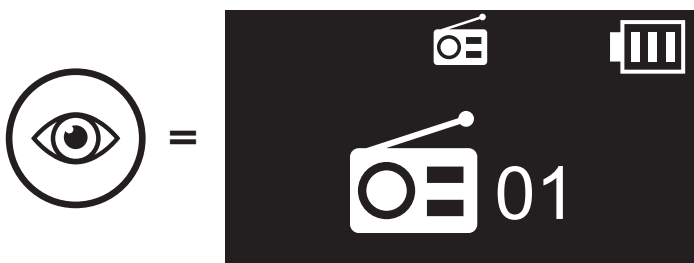
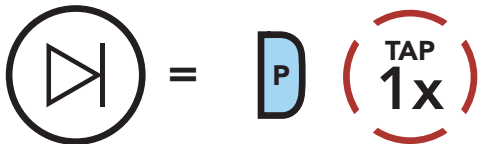

Note: You can use the **Sena Device Manager** or the **Sena Utility App** to save the preset stations.

8.6 FM Sharing

You can listen to the radio during the intercom conversation. To start FM sharing, press and hold the **Phone Button** for **1 second** during the intercom conversation. During FM sharing, you can move to the next preset station and you or your friend on the intercom can change frequencies. If either person changes the frequency, the other will listen to the same frequency. To terminate FM sharing, press and hold the **Phone Button** for **1 second** or end the intercom call.

Navigate through Preset Stations

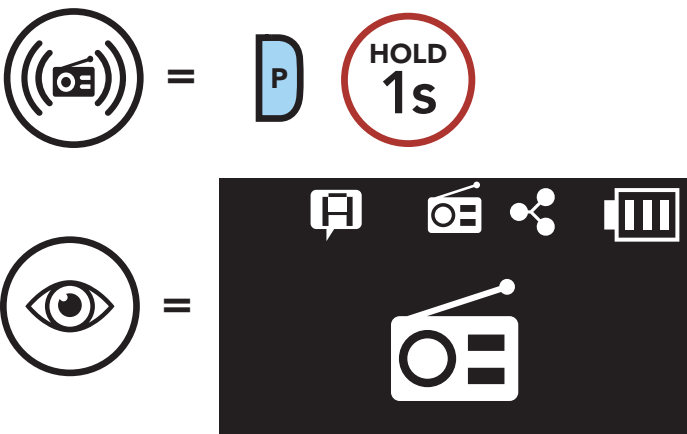

Note: If an intercom call is made while **Audio Multitasking** is enabled and you are listening to the FM radio, **FM Sharing** will not work.

8.7 Region Selection

You can select the proper FM frequency range for your location from the **Sena Device Manager** or the **Sena Utility App**. Using the region setting, you can optimize the seek function to avoid unnecessary frequency ranges.

Region	Frequency range	Step
Worldwide	76.0 ~ 108.0 MHz	± 100 kHz
North America, South America and Australia	87.5 ~ 107.9 MHz	± 200 kHz
Asia and Europe	87.5 ~ 108.0 MHz	± 100 kHz
Japan	76.0 ~ 95.0 MHz	± 100 kHz

9. VOICE COMMAND

The **Voice Command** of the headset allows you to operate certain operations by simply using your voice. You can control the headset completely hands-free using the voice recognition. Multi-language Voice Command supports **English, French, German, Spanish, Italian, Chinese, Japanese, and Russian.**

Speak a Voice Command List

Mode Status	Function	Voice Command
Standby/ Bluetooth Intercom/FM Radio/Music	Check battery	"Hey Sena, Check Battery"
	Volume Up	"Hey Sena, Volume Up"
	Volume Down	"Hey Sena, Volume Down"
	Phone Pairing	"Hey Sena, Phone Pairing"
	Bluetooth Intercom Pairing	"Hey Sena, Pairing Intercom"
	Start/End each Bluetooth Intercom	"Hey Sena, Intercom [one, two, three]"
Standby/ Bluetooth Intercom	Play Music	"Hey Sena, Play Music"
Standby/ Intercom	Turn on FM radio	"Hey Sena, FM Radio On"
Music/FM Radio	<ul style="list-style-type: none"> • FM - Next Preset • Music - Next Track 	"Hey Sena, Next"
	<ul style="list-style-type: none"> • FM - Previous Preset • Music - Previous Track 	"Hey Sena, Previous"
Music	Pause Music	"Hey Sena, Stop Music"
FM Radio	Turn off FM Radio	"Hey Sena, FM Radio Off"
Answer an Incoming Call		"Answer"
Ignore an Incoming Call		"Ignore"

Note:

- You can set a language to another language by using the **Unit Language** feature on the **Sena Utility App**.
- If you set a language that does not support voice commands, the voice command will work only with English commands.
- You can see the other language's voice command list on the **Sena Utility App**.
- **Voice command** performance may vary based on the environmental conditions including riding speed, helmet type and ambient noise. To improve the performance, minimize wind noise on the microphone by using a large microphone sponge and closing the visor.

10. FUNCTION PRIORITY AND FIRMWARE UPGRADES

10.1 Function Priority

The **5S** operates in the following order of priority:

- (highest)** Mobile phone
- Intercom/FM sharing
- Music sharing via Bluetooth stereo music
- Bluetooth stereo music
- (lowest)** FM radio

A lower priority function is always interrupted by a higher priority function.

Note: If you select music as the audio source priority, the order of priority will change as below:

- (highest)** Mobile phone
- Bluetooth stereo music
- Intercom/FM sharing
- Music sharing via Bluetooth stereo music
- (lowest)** FM radio

10.2 Firmware Upgrades

The headset supports firmware upgrades. You can upgrade the firmware using the **Sena Device Manager**. Please visit **sena.com** to check for the latest software downloads.

[Click Here to Visit sena.com](https://www.sena.com)

11. CONFIGURATION SETTING

11.1 Headset Configuration Setting

Access the Configuration Menu

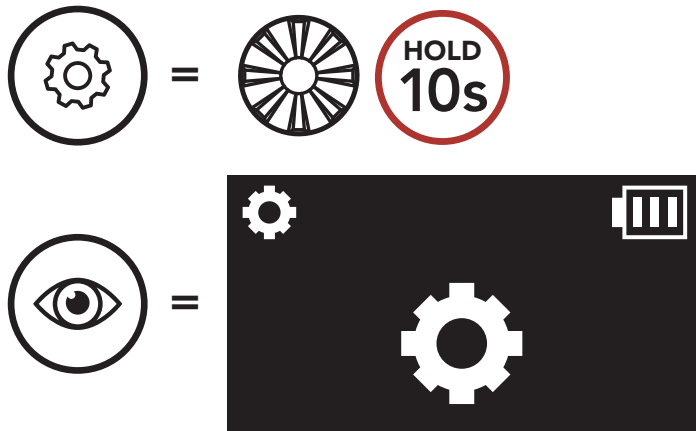

Navigate Between Menu Options

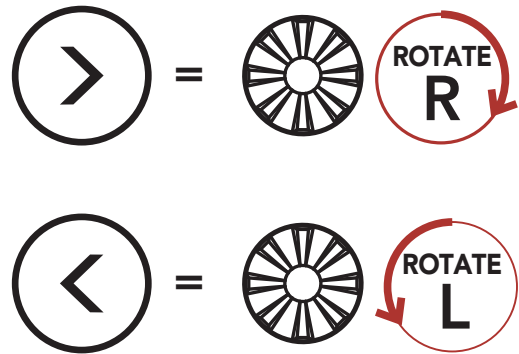

Execute Menu Options

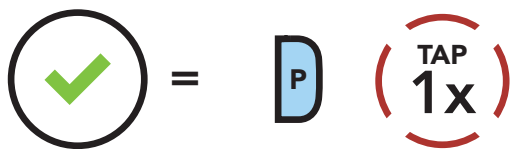

Headset Configuration Menu

Voice Configuration Menu	Tap the Phone Button
Delete All Pairings	Execute
Remote Control Pairing	Execute
Universal Intercom Pairing	Execute
Exit	Execute

11.1.1 Delete All Pairings

Delete All Bluetooth Pairing Information stored in the Bluetooth system.

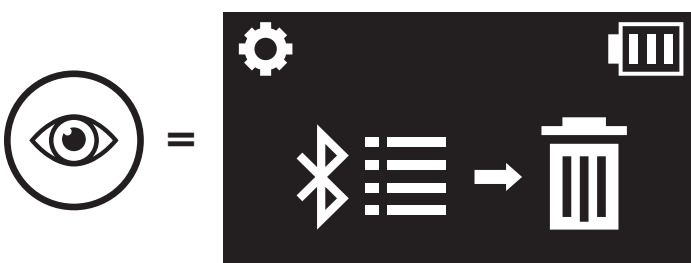

11.1.2 Remote Control Pairing

You can remotely control the headset using **Sena** Remote Control devices (sold separately).

1. Turn on the headset and the Remote Control device.
2. Execute **Remote Control Pairing**.

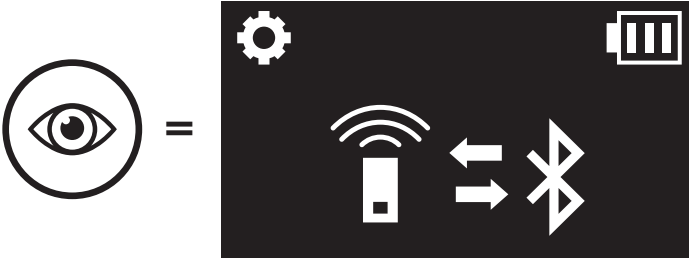

3. Enter pairing mode in the Remote Control device. The headset will automatically connect with the Remote Control device in pairing mode.

11.2 Software Configuration Setting

You can change the settings of the headset through the **Sena Device Manager** or the **Sena Utility App**.

11.2.1 Speed Dial

Assign phone numbers for speed dialing to make a phone call quickly.

11.2.2 Unit Language

You can select the device language. The selected language is maintained even when the headset is rebooted.

11.2.3 Audio Equalizer (Default: Off)

You can use the **Audio Equalizer** to increase/decrease the decibel level of different frequency ranges of audio.

Balance will adjust all of the frequency ranges to be the same volume level (0 dB). **Bass Boost** will increase the bass range of audio (20 Hz - 250 Hz). **Mid Boost** will increase the mid range of audio (250 Hz - 4 kHz). **Treble Boost** will increase the high range of audio (4 kHz - 20 kHz).

11.2.4 VOX Phone (Default: Enable)

If this feature is enabled, you can answer incoming calls by voice. When you hear a ringtone for an incoming call, you can answer the phone by saying a word such as **"Hello"** loudly or by blowing air into the microphone. **VOX phone** is temporarily disabled if you are connected to intercom. If this feature is disabled, you have to tap the **Jog Dial** or the **Phone Button** to answer an incoming call.

11.2.5 VOX Intercom (Default: Disable)

If **VOX Intercom** is enabled, you can initiate an intercom conversation with the last connected intercom friend by voice. When you want to start intercom, say a word such as **"Hello"** loudly or blow air into the microphone. If you start an intercom conversation by voice, the intercom terminates automatically when you and your intercom friend remain silent for 20 seconds. However, if you manually start an intercom conversation by tapping the **Jog Dial**, you have to terminate the intercom conversation manually. However, if you start the intercom by voice and end it manually by tapping the **Jog Dial**, you will not be able to start intercom by voice temporarily. In this case, you have to tap the **Jog Dial** to restart the intercom. This is to prevent repeated unintentional intercom connections by strong wind noise. After rebooting the headset, you can start the intercom by voice again.

11.2.6 Audio Source Priority (Default: Intercom)

Audio Source Priority allows you to select the priority between the intercom and music (which includes GPS app instructions and message notifications) from a smartphone. If the intercom is selected as the audio source priority, your music will be interrupted during an intercom conversation. If music is selected as the audio source priority, intercom conversations will be interrupted while your music is heard.

Note: **Audio Source Priority** is active only when **Audio Multitasking** is disabled.

11.2.7 Audio Multitasking™ (Default: Disable)

Audio Multitasking allows you to hear the audio from two features simultaneously. When **Audio Multitasking** is enabled, phone calls, GPS instructions and intercom conversations can be overlaid with audio from the FM radio, music or GPS app instructions from a smartphone in the background with reduced volume. Increasing or decreasing the volume of the audio in the foreground will also increase or decrease the volume of the overlaid audio in the background. The volume of the foreground audio can be adjusted using the headset. How much background audio that is heard can be adjusted using the **Sena Device Manager** or the **Sena Utility App**. **HD Intercom**, **HD Voice** and **Audio Source Priority** become disabled temporarily when **Audio Multitasking** is enabled.

Foreground and Background Combination Table

Model	Foreground*			Background**	
	Phone	GPS	Intercom	FM Radio	Music or Smart Navi
5S	○ ^A	○ ^A			
		○	○		
			○ ^B	○	○ ^B
		○ ^C		○ ^C	○

* Two audio sources in the foreground can be heard simultaneously with the same volume level.

** Only one background source can be heard at a time while listening to an audio source in the foreground.

A. GPS instructions can be heard during phone calls and the volume level of both audio sources can be adjusted using the headset.

B. GPS app directions will be heard in the background during intercom conversations.

C. The FM radio will be heard in the background when GPS instructions are heard.

Note:

- **Audio Multitasking** will be activated during two-way intercom conversations with a headset that also supports this feature.
- When **Audio Multitasking** is disabled, the background audio source will return to its independent volume level.
- **Audio Multitasking** has limited usage for iOS devices.
- For **Audio Multitasking** to work properly, you need to power the headset off and on. Please restart the headset.
- Some GPS devices may not support this feature.

11.2.8 Background Volume (Default: Level 5)

The **Background Volume** can be adjustable only when the **Audio Multitasking** turns on. Level 9 is the highest volume and 0 is the lowest.

11.2.9 HD Intercom (Default: Enable)

HD Intercom enhances the two-way intercom audio from normal quality to HD quality. If this feature is disabled, the two-way intercom audio will change to normal quality.

Note:

- The intercom distance of **HD Intercom** is relatively shorter than that of normal intercom.
- **HD Intercom** will become disabled temporarily when **Audio Multitasking is enabled**.

11.2.10 HD Voice (Default: Enable)

HD Voice allows you to communicate in high-definition during phone calls. This feature increases the quality so that the audio will be crisp and clear during phone call conversations.

If this feature is enabled, incoming phone calls will interrupt intercom conversations and audio from the SR10 will not be heard during intercom conversations.

Note:

- Refer to the manufacturer of your Bluetooth device that will be connected to the headset to see if it supports **HD Voice**.
- **HD Voice** is active only when **Audio Multitasking** is disabled.

11.2.11 Sidetone (Default: Disable)

Sidetone is audible feedback of your own voice. It helps you to naturally speak at the correct level according to varying helmet noise conditions. If this feature is enabled, you can hear what you are speaking during an intercom conversation or a phone call.

11.2.12 Voice Prompt (Default: Enable)

You can disable voice prompts by software configuration settings, but the following voice prompts are always on.

- Headset configuration settings menu, battery level indicator, speed dial, FM radio functions

11.2.13 RDS AF Setting (Default: Disable)

Radio Data System (RDS) Alternative Frequency (AF) Setting allows a receiver to re-tune to the second frequency location when the first signal becomes too weak. With RDS AF enabled on the receiver, a radio station with more than one frequency can be used.

11.2.14 FM Station Guide (Default: Enable)

When **FM Station Guide** is enabled, FM station frequencies are given by voice prompts as you select preset stations. When **FM Station Guide** is disabled, the voice prompts on FM station frequencies will not be given as you select preset stations.

11.2.15 Advanced Noise Control™ (Default: Enable)

When **Advanced Noise Control** is enabled, the background noise is reduced during an intercom conversation. When it is disabled, the background noise is mixed with your voice during intercom.

12. TROUBLESHOOTING

Please visit sena.com for answers to frequently asked questions. This detailed online FAQ section deals with troubleshooting, illustrates case studies and contains tips on using the headset.

[Click Here to Visit sena.com](http://sena.com)

12.1 Fault Reset

When the headset is not working properly, you can easily reset the unit:

1. Locate the **pinhole reset button** below on the back of the main unit.
2. Gently insert a paperclip into the hole and tap the **Fault Reset Button** with light pressure.

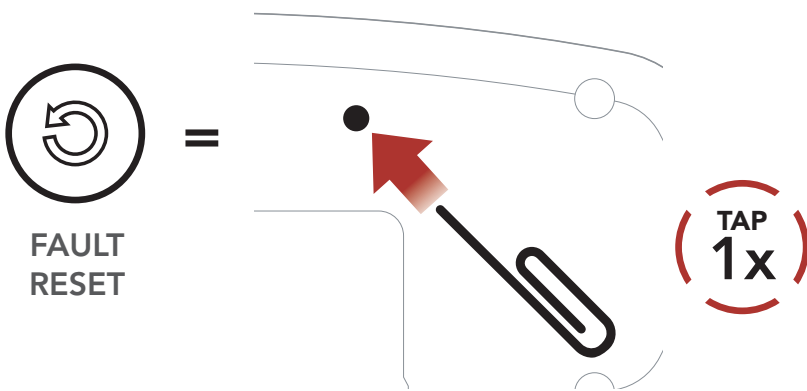

3. The headset will shut down.

Note: **Fault Reset** will not restore the headset to factory default settings.

12.2 Factory Reset

To erase all of your settings and start fresh, the headset can be restored to factory default settings using the **Factory Reset** feature.

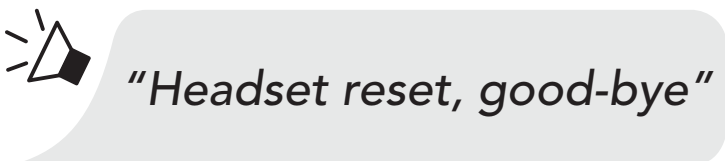
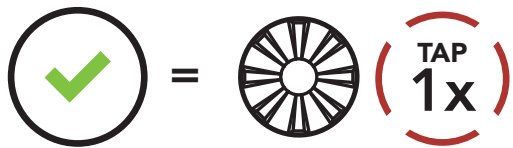
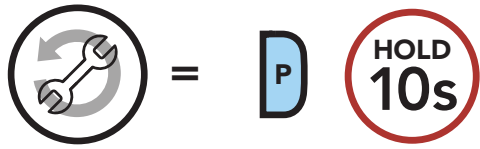

Note: If you press the **Phone Button** or do not press the **Jog Dial** within **5 seconds**, the reset attempt is canceled and the headset returns to standby mode. You will hear a voice prompt saying **"Canceled"**.



Copyright © 2020 Sena Technologies, Inc.
All rights reserved.

© 1998–2020 Sena Technologies, Inc. All rights reserved.

Sena Technologies, Inc. reserves the right to make any changes and improvements to its product without providing prior notice.

Sena™ is a trademark of Sena Technologies, Inc. or its subsidiaries in the USA and other countries. SF1™, SF2™, SF4™, SFR™, SRL™, Momentum™, Momentum INC™, Momentum Lite™, Momentum Pro™, Momentum INC Pro™, Momentum EVO™, Cavalry™, Latitude SR™, Latitude SX™, 30K™, 50S™, 50R™, 5S™, 20S EVO™, 20S™, 10S™, 10C™, 10C PRO™, 10C EVO™, 10U™, 10Upad™, 10R™, 3S™, SMH5™, SMH5-FM™, SMH5 MultiCom™, SMH10™, SMH10R™, SPH10™, SPH10H-FM™, Savage™, Prism Tube WiFi™, Prism™, Bluetooth Audio Pack for GoPro®, R1™, R1 EVO™, R1 EVO CS™, M1™, RC1™, RC3™, RC4™, Handlebar Remote™, Wristband Remote™, PowerPro Mount™, Powerbank™, FreeWire™, WiFi Docking Station™, WiFi Sync Cable™, +mesh™, +Mesh Universal™, Econo™, OUTRUSH™, OUTSTAR™, EcoCom™, Parani M10™, SR10™, SR10i™, SM10™, X1™, X1 Pro™, Expand™, Bluetooth Mic & Intercom™, Tufftalk™, Tufftalk Lite™, Tufftalk M™ are trademarks of Sena Technologies, Inc. or its subsidiaries. These trademarks may not be used without the express permission of Sena.

GoPro® is a registered trademark of Woodman Labs of San Mateo, California. Sena Technologies, Inc. ("Sena") is not affiliated with Woodman Labs, Inc. The Sena Bluetooth Pack for GoPro® is an aftermarket accessory specially designed and manufactured by Sena Technologies, Inc. for the GoPro® Hero3 and Hero4 allowing for Bluetooth capabilities.

The Bluetooth® word mark and logos are owned by the Bluetooth SIG, Inc. and any use of such marks by Sena is under license. iPhone® and iPod® touch are registered trademarks of Apple Inc.

Address: 152 Technology Drive Irvine, CA 92618